

Instructions for use GRAVITY

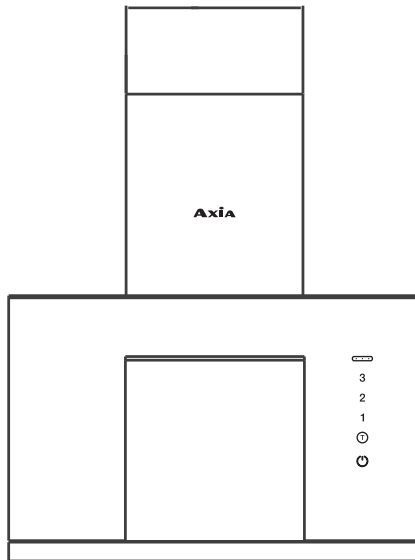

Contents

To the user	04
Company profile	04
1.Packing list	05
2.Technical parameters	06
3.Installation cautious	07
4.Installation diagram	08
5. Range hood operations	09
6. Use and care information	11
7. Troubleshooting	13
8. Circuit diagram	14
9.Structural diagram	15
10.Environmental impact report	17
11.The content of harmful substances in products	17
12.After-sale service	18
13.Hione product warranty card	18
Product Installation Card(First Copy)	
Product Installation Card(Second Copy)	

To the user

Dear Valued Customer:

Thank you for purchasing Range Hood of HIONE. For your convenience, please read the instructions carefully, installed and use the range hood according to the user manual. Please keep the manual for future reference.

Combined with the advantages of domestic and foreign hoods, this product is designed according to modern kitchen environment and cooking characteristics. Based on aerodynamic principles, this range hood is the ideal kitchen home accessories to increase your quality of life.

With the advanced production line, full complement of testing equipment, our products are quality and reliable.

Company profile

SHENZHEN HIONE GAS APPLIANCE CO.,LTD, also known as Hione was founded in 1992. Hione is a comprehensive high-end kitchen appliances manufacturers which includes independent research, production, sales and service capabilities. Moreover, Hione is one of the export company that have independent intellectual property rights with its own kitchen appliances brand. Hione pays high attention to quality and always adhere to promote the creation of high quality, efficient, energy saving appliances to the consumers.

25 years of dedicated, innovative and enterprising, Hione won the honor and approval from consumers and society. But still, the road ahead will be long and our climb will be steep, Hione will never arrogant and slack. Hione will continue to strive to create value for consumers and the society!

1.Packing List

NO.	Category	Quantity
1	Main unit	1
2	Installation hanging board, anti-skid off device	1
3	Plastic expansion plug	4
4	Wood screws	4
5	Check valve	1
6	Exhaust pipe	1
7	Fastening screw for exhaust pipe	2
8	Oil Cup	1
9	Instructions	1
10	Qualification Certificate	1
11	Extension cover fixed rubber stopper	3
12	Extension cover fixing screw	3
13	Extension cover strut	1
14	Extended cover fixing plate	1

2. Technical Parameters

Parameters	CA01	CA02	CB01	CB02	CB03
Model					
Power supply	220-240V~/50Hz				
Motor power	218W				
Suction power	1,600 m ³ /h				
Illumination power	≤1.5w×2				
Diameter of exhaust pipe	Φ160mm				
Air flow m ³ /min	15±1.5				
Wind pressure	≥260pa				
Maximum static pressure	≥350pa				
Noise of sound power level	68dB				
Total pressure efficiency	23%				
Standby power	0W				
Off power	1.0W				
Oil separation degree	≥80%				
Normal odor reduction	≥95%				
Net weight	27kg				
Product size	900×460×1003(mm)				

3. Installation Cautious

Important Note

If you are refurbishing your kitchen, do not expose the range hood. Because the building materials, dust, paint and the gas they volatile would corrode the surface of the range hood to make it loss of luster. Hione recommended that install the hood after you finished the renovation.

- 1) The earth wire of electrical socket should be reliable.
- 2) The environmental conditions of using this machine: temperature should be -15 ℃ ~ 40 ℃, relative humidity ≤ 90% (25 ℃), altitude ≤ 1000m. Please don't install this product in large air convection environment in case of effecting the smoke discharge.
- 3) The machine should be installed above the stove and to maintain the horizontal level. The minimum range of range hood cooking utensils to the stove should not less than 65cm.
- 4) The installation of rear exhaust pipe to the product should not be too long, no too much turning in case of effecting the smoke discharge.
- 5) Exhaust gas from the range hood is not allowed to be discharged into a hot flue which use to discharge combustion gases or other combustion fumes.
- 6) Make sure that the wall is strong enough to install the hood.
- 7) To ensure safety and smooth installation, please use the equipped accessories to install. Do not drill too much so that the expansion pipe and wall hole should be tightly matched which could avoid accidental fall.
- 8) To avoid fire incident, please exhaust the smoke to the outdoor.
- 9) During installation, please ensure the machine is installed above the stove and to maintain the horizontal level.
- 10) If you need to move the gas hobs before installing the range hood, please turn off the gas valve before moving the gas hobs.
- 11) Due to the installation of the range hood is more complex and heavier in weight, it is

best installed by the professional staff in accordance with the manual.

12) Range hoods may have very sharp edges. Please wear protective gloves when moving the hood for installation, cleaning or repair.

Installation Procedure (Please refer to the installation diagram)

- 1, Open the hole of the exhaust pipe: choose the row of the position of the exhaust tube and drill a hole in larger diameter than the exhaust pipe 5-10mm on the wall.
- 2, Install the hook: According to the installation diagram, drill four $\Phi 8\text{mm}$, 50mm deep holes, put the expansion plug into the hole, fixed rack with wood screws.

4. Installation diagram

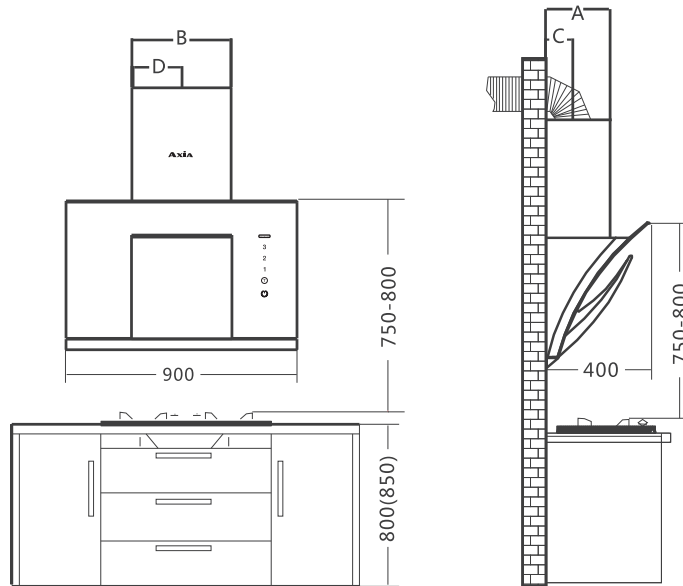

Model Parameters		CA01	CA02	CB01	CB02	CB03
Installation size	A(mm)	275				
	B(mm)	387				
	C(mm)	120				
	D(mm)	124				

A-Decorative cover thickness

B-Decorative cover width

C-The distance from the center of the air outlet to the back of the trim cover

D-The distance from the center of the air outlet to the left side of the trim cover

5. Range Hood Operations

Induction switch operation interface:

GV-H90 series switch operation interface description:

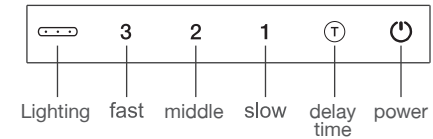

Button function and operating instructions:

- 1, Lighting : Touch the button to turn on the light and the button lights on, touch it again to turn off the light and the button lights off.
- 2, Fast Mode :Touch this button in the standby mode, the button lights on and the motor runs at high speed, it is suitable for frying with fire-red fire with large amount of smoke. Touch again to turn off the motor and the button lights off.
- 3, Middle Mode :Touch this button in the standby mode, the button lights on and the motor runs at middle speed. It is suitable for frying, decoying and stewing food with strong fire. Touch again to turn off the motor and the button lights off.
- 4, SlowMode: Touch this button in the standby mode, the button lights on and the motor runs at low speed. It is suitable for frying, decoying and stewing food with strong fire. Touch again to turn off the motor and the button lights off.

5, **Delay time:** Touch the button in the working mode or standby mode, the button light flashes.

The motor runs at low speed, delay about 1 minute the power will automatically off, stop operating. It is used after finish cooking.

6, **Power :** After the range hood connected to power supplies, touch the power button and button lights on, the range hood turn into the standby mode. In the standby mode, touch the button to turn off the power and the button lights off. In the working mode, touch the button to turn off the power and the motor stops, button lights off.

6. Use and care information

In order to operate the machine with best performance, extend the life time, please:

- 1, Clean the shell and the smoke chamber when you finish cooking.
- 2, Regularly clean the net mask component, please unplug the power plug before cleaning. Please use neutral detergent and soft cloth to scrub, do not use hard objects to scrape, wipe the body and parts to prevent damage to the rust layer. Be careful not to allow water to enter the body, do not pull the electrical connection.
- 3, When you clean the impeller , please remove the trim cover, air guide and other related components first. Model F5, F6, F8 should be removed the air guide plate, and then loosen the impeller lock nut, remove the impeller (be careful not to let impeller forced or knocked which will cause deformation), immersed in the detergent. After clean and dry, install the components carefully.
- 4, Please turn off the power when replace the light and follow the instruction manual.
- 5, If the power supply cord is damaged, please use the special power supply cord of the manufacturer and contact the manufacturer or professional personnel to replace it.
- 6, Please keep the motor and all the electrical parts away from water.
- 7, Do not use gasoline, acid, benzene, solvents or any other chemical to clean range hood.
- 8, Do not allow stains to stay on the surface of the hood for too long.
- 9, When the fan is working, please don't clean the hood or put your hands into the operation area.
- 10, Cleaning oil cup: hold the both end of the oil cup and pull out gently, pour off the oil , clean the oil tank and re-install into the oil sump .

Recommendation:

- 1, Please wipe the surface of the hood once you finished cooking.
- 2, Clean the air inlet every three days.
- 3, Clean the impeller every year (this is only limited to professional cleaning)

⚠ Please ensure to keep the room to be well ventilated when using the range hood and any stove at the same time.(this condition does not apply to a range hood that discharges gas out of the room)

⚠ Flushing the inside and outside of the machine with the water is prohibited. There is the risk of fire if you don't follow the cleaning method of the instruction.

⚠ Do not let the stove fire directly contact range hood.

7. Troubleshooting

Please make sure to turn off the power when abnormal conditions are found.

Conditions	Cause	Approach
Suction is not strong	<ol style="list-style-type: none">1. Installation is too high2. The kitchen air convection is too strong3. Duct is too long4.The outdoor wind is too strong5. Oil filter plate or impeller stock too much oil6. Motor speed decreases	<ol style="list-style-type: none">1.Install to the appropriate position2. Adjust the window3. Change the position of the cooking stove, shorten the duct length4. Change the direction of the outlet5. Clean the screen or impeller6.Replace the motor and capacitor
Motor does not work	<ol style="list-style-type: none">1. The power plug is not tightened2. Over-temperature protection3. Capacitor damage4. The motor burns out or stuck	<ol style="list-style-type: none">1. Plug the plug2. After cooling,it can be used normally3. Replace Capacitor4. Replace the motor
The body vibrates obviously	<ol style="list-style-type: none">1. The main unit is not firm2. The impeller shaft fixing nut is loose3. Impeller installation is not in the right place4. The motor mounting screw is loose5. Impeller damage to be deformation	<ol style="list-style-type: none">1. Tighten the hanging plate screws2. Tighten the impeller nut3. Impeller installed in place, tighten the impeller nut4. Tighten the motor mounting screws5.Adjust or replace the impeller

8. Circuit Diagram

GV-H90 Series

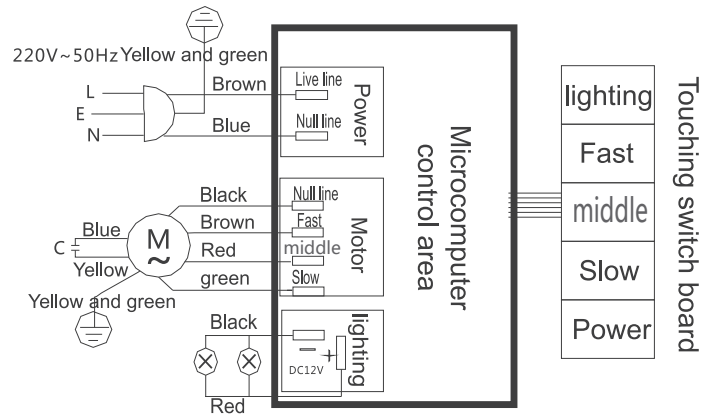

9. Structural Diagram

CA Series

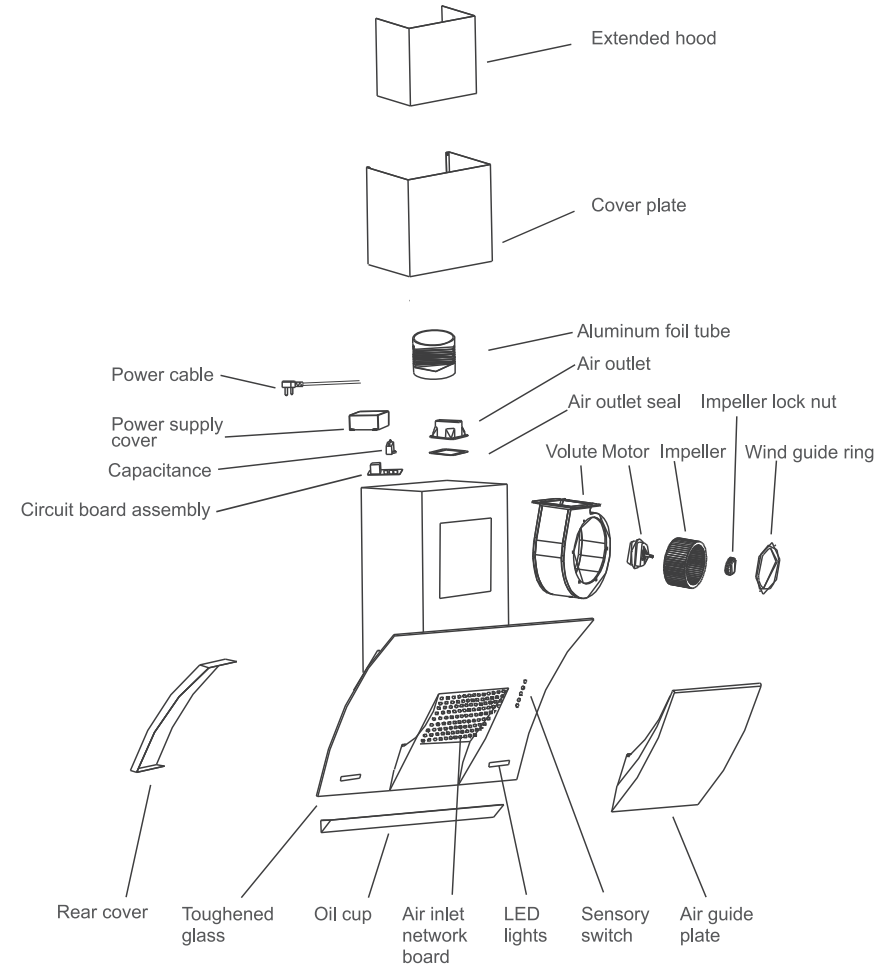

CB Series

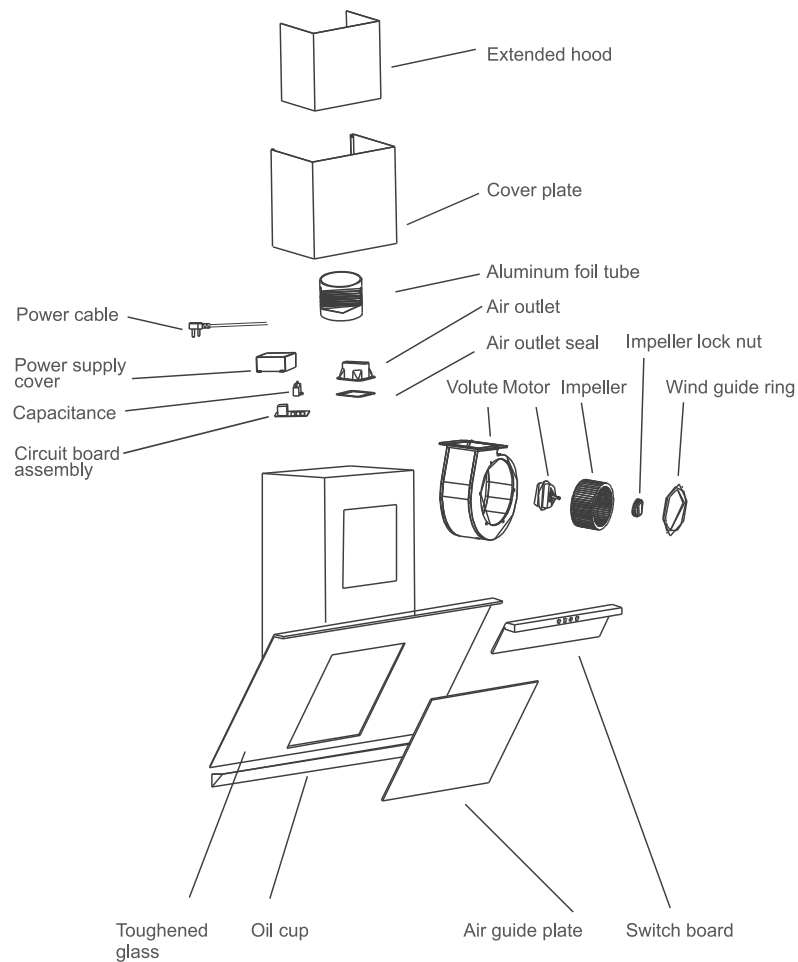

10.Environmental Impact Report

This product packaging materials can be re-use of packaging materials, please consult the correct handling of recycling to avoid pollution of the environment.

11.The content of harmful substances in products (Range Hood)

Part Name	Harmful Substance					
	Pb	Hg	Cd	Cr(VI)	PBB	PBDE
Metal parts	×	○	○	×	○	○
Plastic parts	○	○	○	○	○	×
Rubber parts	○	○	○	○	○	○
Printed parts	○	○	○	○	○	○
Glass pieces	×	○	×	○	○	○
Lamp assembly	×	×	×	×	×	×
Electronic component	×	○	○	○	○	×
Motor	×	○	○	×	○	○
Power cable	×	○	○	○	○	○
Capacitance	×	×	×	×	×	×

This form is prepared in accordance with the provisions of SJ/T 11364-2014.

○ :Indicating that the hazardous substances in the components of all homogeneous materials is under the GB/T 26572-2011 requirements limited requirements;

× :Indicating that the hazardous substances in the components of all homogeneous materials is exceed the GB/T 26572-2011 requirements limited requirements;

12.After-sales service

If found any abnormality during using,please check the symptoms and troubleshooting methods. Please contact Hione maintenance station (Hione set up various distribution in the country) if you could not handle the problem.

13.Hione product warranty card

All the range hoods that purchased in our company are guaranteed to keep in good repair for one year from the purchased date. If found quality problems happen during guarantee period, our company will provide maintenance service for free. Additionally, our company provides maintenance support for life. We offer half year free maintenance for non home usage. Please complete the form as below to ensure the customers could enjoy maintenance service.

Model		Sales Contact Number	
Serial number		Service Contact Number	
Customer name		Address	
Purchased date		Invoice number	
Maintenance record (filled out by maintenance person)			
Maintenance content		Sign of maintenance person	Date

AXIA Product Installation Card

Customer name		Contact number	
Address			
Product name		Product model	
Purchase store		Invoice number	
Purchase date		Product bar code	
Installation effect	<input type="checkbox"/> Great <input type="checkbox"/> General <input type="checkbox"/> Poor	Service attitude	<input type="checkbox"/> Great <input type="checkbox"/> General <input type="checkbox"/> Poor
Customer comments:			
Installer signature		date	
Customer signature		date	

Axia Product Installation Card

Customer name		Contact number	
Address			
Product name		Product model	
Purchase store		Invoice number	
Purchase date		Product bar code	
Installation effect	<input type="checkbox"/> Great <input type="checkbox"/> General <input type="checkbox"/> Poor	Service attitude	<input type="checkbox"/> Great <input type="checkbox"/> General <input type="checkbox"/> Poor
Customer comments:			
Installer signature		date	
Customer signature		date	

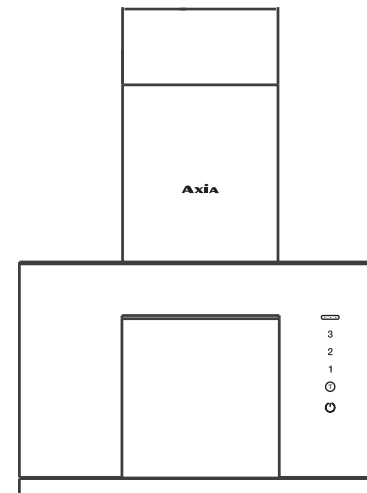

Axia